

## Rotor Flow Indicator for Fluids



- Viscosity: 1 -150 mm<sup>2</sup>/s
- Indication Range:  
0.4-4...8-100 l/min. water
- p<sub>max</sub> 16 bar; t<sub>max</sub> 100°C
- Connection:  
G 1/4...G 1 1/2 IG;  
1/4"...1 1/2" NPT
- Material:  
brass, stainless steel



KOBOLD offices exist in the following countries:

**ARGENTINA, AUSTRIA, BELGIUM, BRAZIL, CANADA, CHINA,  
COLOMBIA, FRANCE, GREAT BRITAIN, ITALY, NETHERLANDS,  
POLAND, SWITZERLAND, USA, VENEZUELA**

KOBOLD Messring GmbH  
Nordring 22-24  
D-65719 Hofheim/Ts.  
☎ (06192) 299-0  
Fax (06192) 23398  
E-mail: info.de@kobold.com  
Internet: www.kobold.com

**Model:**  
DAH-1



**Application**

The Kobold Flow Indicators DAH are used for mounting in pipes for fluids. The instruments are equipped with female threads at inlet and outlet and can be supplied with either brass or stainless steel fittings.

**Dimensions**

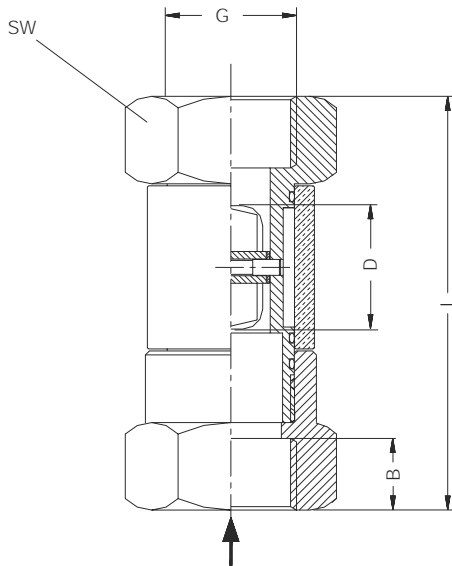

**Materials**

- Housing: Brass nickel plated (DAH-11..) st. st. 1.4305 (DAH-12..)
- Inlet: Brass nickel plated (DAH-11..) st. st. 1.4305 (DAH-12..)
- Sight glass: Duran
- O-rings: NBR (DAH-11..) FPM (DAH-12..)
- Rotor: POM (DAH-11..) Hostafion (DAH-12..)
- Rotor axle: st. st. 1.4305

	Standard size DN	Female thread G	Female thread NPT	Thread length B DIN 3852	Total length L	Spanner size SW
	DN mm	G	NPT	B mm	L mm	SW mm
DAH-...01H	8	1/4	1/4"	12	71	36
DAH-...02H	10	3/8	3/8"	12	71	36
DAH-...03H	15	1/2	1/2"	14	86	46
DAH-...04H	20	3/4	3/4"	16	94	46
DAH-...05H	25	1	1"	18	104	46
DAH-...06H	32	1 1/4	1 1/4"	20	120	65
DAH-...07H	40	1 1/2	1 1/2"	22	130	65

**Order details** (Example: DAH-1101H R08)

DN	Indication range	$\Delta p$ at $Q_{max}$	$p_{max}$	$t_{max}$	Weight	Model		Connection thread	
						Brass w/rotor	St. st. w/rotor	G	NPT
1/4"	0.4 - 4	0.25	16	100	0.3	DAH-1101H..	DAH-1201H..	R08	N08
3/8"	0.6 - 8	0.25	16	100	0.28	DAH-1102H..	DAH-1202H..	R10	N10
1/2"	1 - 12	0.25	16	100	0.6	DAH-1103H..	DAH-1203H..	R15	N15
3/4"	1 - 25	0.25	16	100	0.65	DAH-1104H..	DAH-1204H..	R20	N20
1"	1.6 - 40	0.25	16	100	0.7	DAH-1105H..	DAH-1205H..	R25	N25
1 1/4"	8 - 80	0.25	16	100	1.5	DAH-1106H..	DAH-1206H..	R32	N32
1 1/2"	8 - 100	0.25	16	100	1.6	DAH-1107H..	DAH-1207H..	R40	N40