

9100-9200-9500 series

Subminiature momentary pushbutton switches



DISTINCTIVE FEATURES

- Panel and PC mount models, horizontal or vertical
- Self-cleaning and butt action contacts
- Several plunger options



ELECTRICAL SPECIFICATIONS

- Max. current/voltage rating with resistive load : 100 mA 30 VDC
- Initial contact resistance : 30 mΩ max.
- Insulation resistance : 1,000 MΩ min. at 500 VDC
- Dielectric strength :
500 Vrms 50 Hz min. between terminals
1,000 Vrms 50 Hz min. between terminals and frame
- Electrical life at full load :
9100 - 9200N and 9500N : 250,000 cycles
9200 - 9500 : 100,000 cycles



GENERAL SPECIFICATIONS

- Torque : 0.5 Nm (.590 Ft.lb) max. applied to nut
- Operating temperature : -30 °C to +65 °C (-22 °F to +146 °F)
- Panel thickness : 1.50 mm (.059) max.
- Travels : see table below . Tolerance : ± 0.3 mm (.011)

	9533-9233	9532-9232	9533N 9233N-9133
Total travel	1.10 (.043)	1.80 (.070)	1 (.039)
Pre-travel	0.80 (.031)	1.00 (.039)	-
Over travel	0.30 (.011)	0.75 (.029)	-



MATERIALS

- Case : Pa6T
- Actuator : polyamide, glass filled
- Bushing : brass, nickel plated
- Contacts : CD : brass, gold plated
- Terminal seal : epoxy

APEM products may be recycled at end-of-life for the re-claiming of valuable metal components.

The company reserves the right to change specifications without notice.



9100-9200-9500 series

Subminiature momentary pushbutton switches



TERMINALS

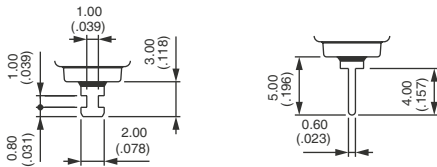

ELECTRICAL FUNCTIONS

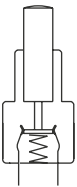

Function 2 (NC)

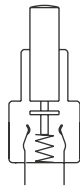

Function 3 (NO)



PANEL CUT-OUT

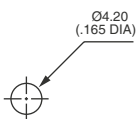

STANDARD HARDWARE (FOR THREADED BUSHING MODELS)

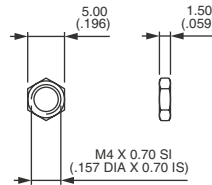

U544 (nickel plated)

Available models

9133CD ; 9133CD4
9133CDK0 ; 9133WWCD
9133WWCD4 ; 9133YCD
9232CD ; 9232WWCD
9232YCD ; 9233CD
9233CD4 ; 9233CD4+U4316
+U4922
9233NCD ; 9233NCD4
9233NYCD ; 9233NYCD4
9233WWCD ; 9233WWCD0
9233YCD ; 9532CD
9532CD4 ; 9532NCD3
9533CD ; 9533CD0
9533CD4 ; 9533NCD
9533NCD0 ; 9533NCD4
9533NCDK ; 9533NCDK0
9533NCDK4

9100-9200-9500 series

Subminiature momentary pushbutton switches



BUILD YOUR PART NUMBER

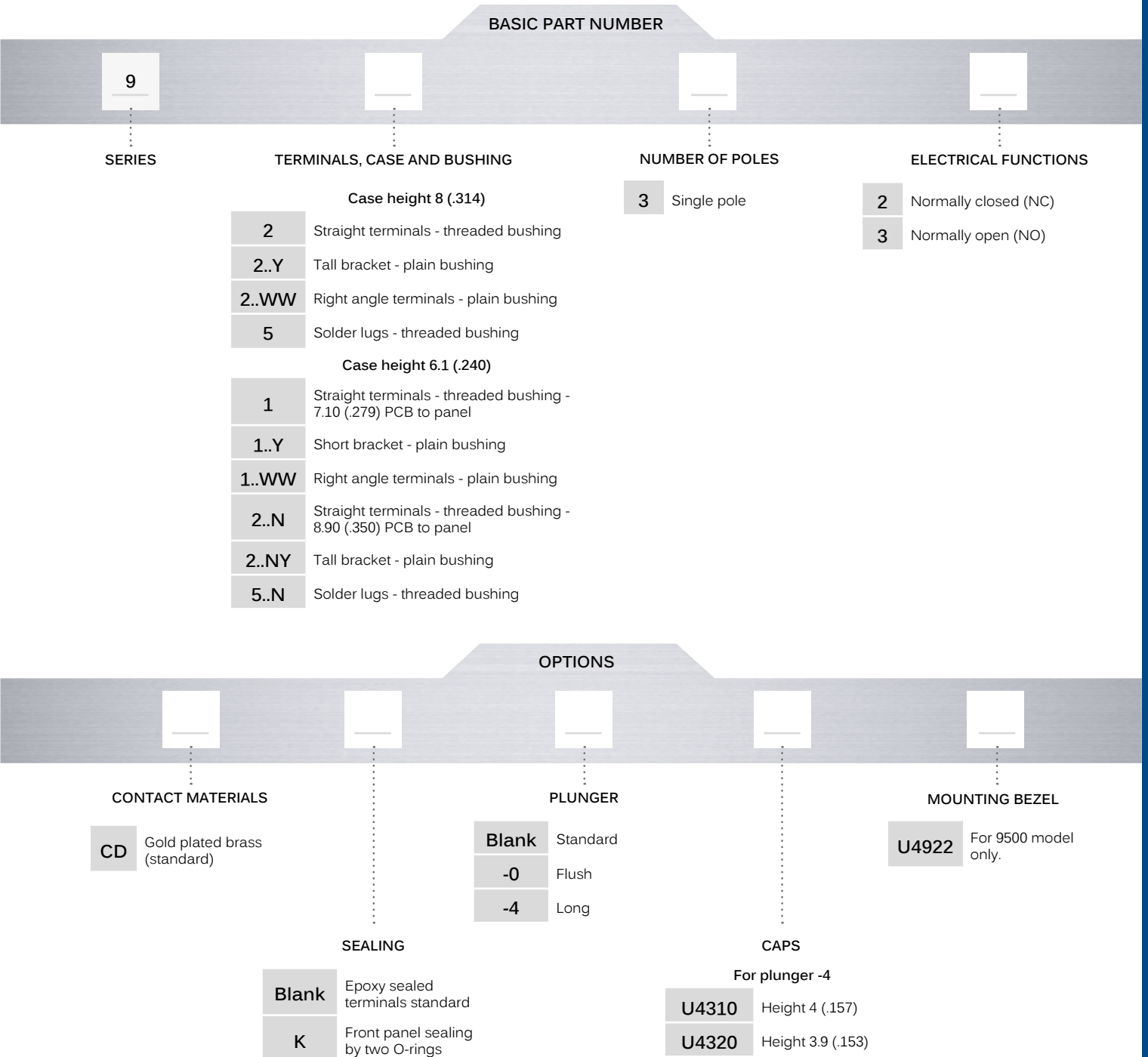

ABOUT THIS SERIES

On the following pages, you will find successively basic part numbers of switches and options in the same order as in above chart.

- ⚠ **Notice** : please note that not all combinations of above numbers are available. Refer to the following pages for further information.
- 💧 **Sealing boots** are available to protect the switches. See "Sealing Boots" section of website.
- 🔩 **Mounting accessories** : standard hardware supplied with all threaded bushing models : 1 nickel plated hex nut 5 (.196) across flats, part number U544. This nut is presented on previous page.

9100-9200-9500 series

Subminiature momentary pushbutton switches

LONG CASE - SOLDER LUGS : 9500

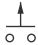

9532  Normally Closed

9533  Normally Open

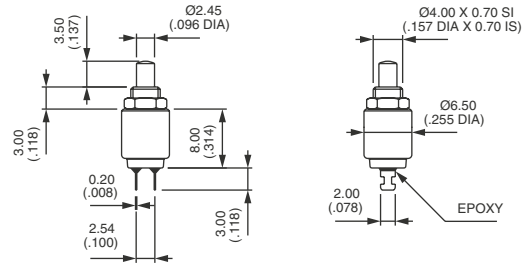

LONG CASE - STRAIGHT PC TERMINALS : 9200

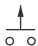

9232  Normally Closed

9233  Normally Open

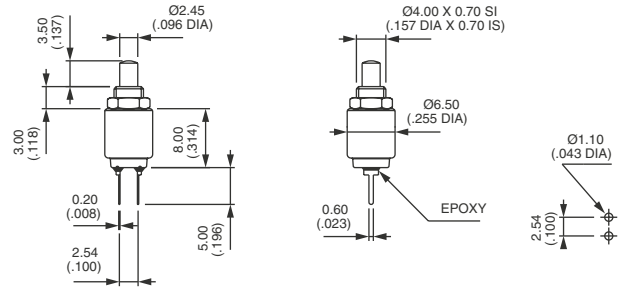

LONG CASE - STRAIGHT PC TERMINALS BRACKET MOUNTING : 9200Y



9232Y  Normally Closed

9233Y  Normally Open

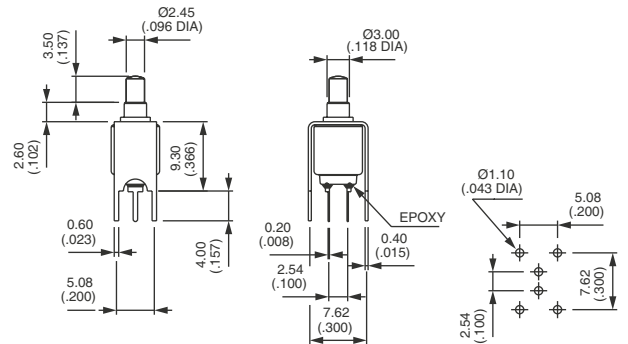

LONG CASE - RIGHT ANGLE TERMINALS : 9200WW

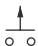

9232WW  Normally Closed

9233WW  Normally Open

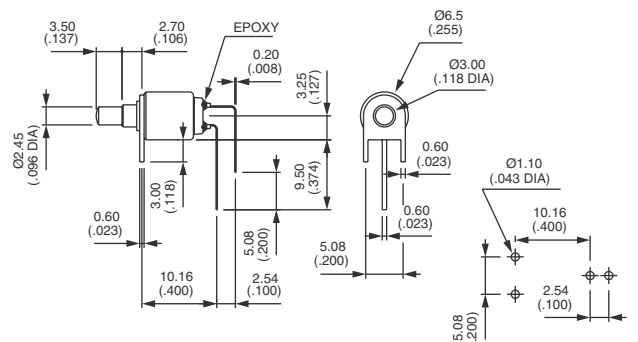

9100-9200-9500 series

Subminiature momentary pushbutton switches

SHORT CASE - SOLDER LUGS : 9500N



9533N  Normally Open

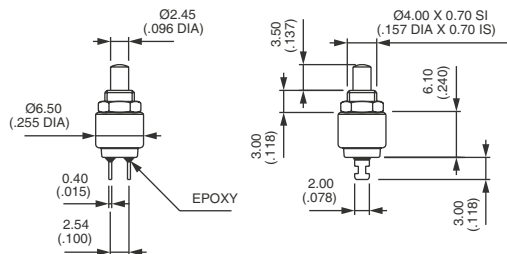

SHORT CASE - STRAIGHT PC TERMINALS 8.90 (.350) PCB TO PANEL



9233N  Normally Open

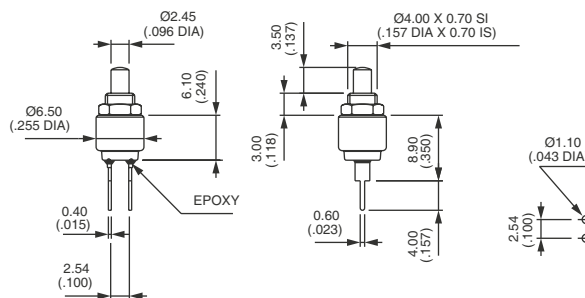

SHORT CASE - STRAIGHT PC TERMINALS 7.10 (.279) PCB TO PANEL



9133  Normally Open

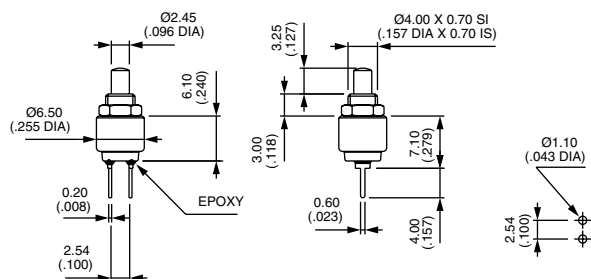

SHORT CASE - STRAIGHT PC TERMINALS TALL BRACKET : 9200NY



9233NY  Normally Open

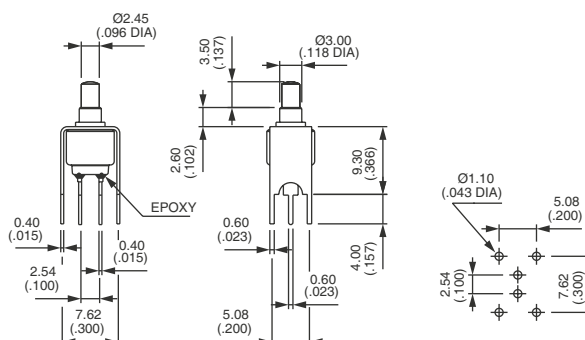

9100-9200-9500 series

Subminiature momentary pushbutton switches

SHORT CASE - STRAIGHT PC TERMINALS SHORT BRACKET : 9100Y



9133Y



Normally Open

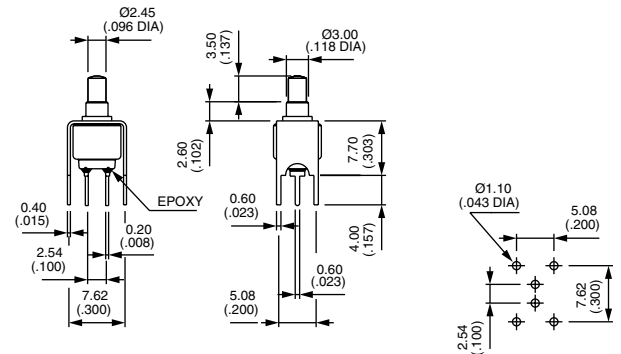

SHORT CASE - RIGHT ANGLE TERMINALS - VERTICAL : 9100WW



9133WW



Normally Open

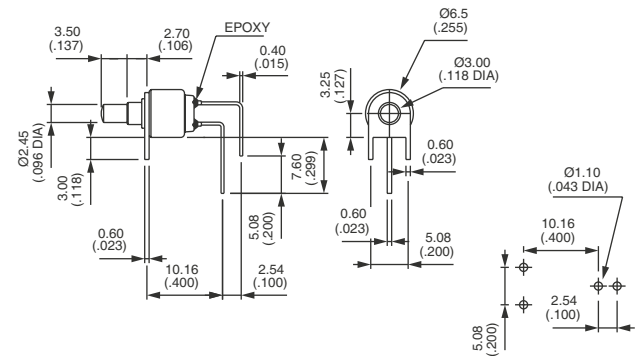

CONTACT MATERIALS

BASIC P/N

CD Gold plated brass (standard)

SEALING

BASIC P/N

- Blank Epoxy sealed terminals standard
- K Front panel sealing by two O-rings. Protects the switch against water and dust. Panel seal withstands 0.1 bar pressure.
- ⚠ Option K for models 9533N, 9233N and 9133 only.

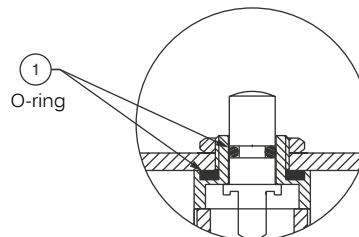

9100-9200-9500 series

Subminiature momentary pushbutton switches

PLUNGERS

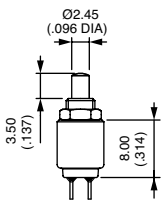
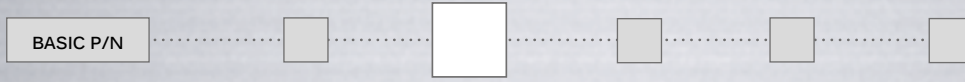

Blank
Standard
with long case

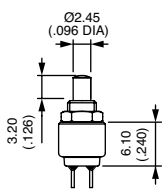

Blank
Standard
with short case

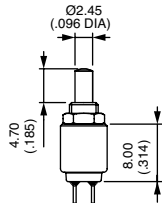

-4
Long
with long case

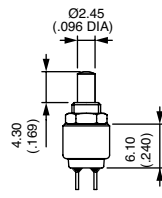

-4
Long
with short case

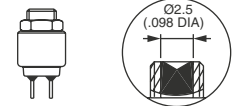

-0
Flush

CAPS

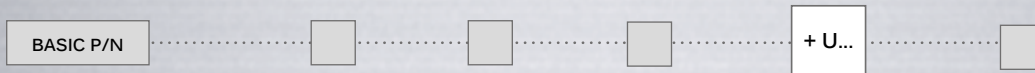

U4310 For use with plunger -4 only

U4320 For use with plunger -4 only

For cap colors, replace "0" with number :

- 1 Blue
- 1/4 Dark blue
- 2 Black
- 3 Green
- 4 Grey
- 5 Yellow
- 6 Red
- 7 Ivory
- 7/1 White
- 9 Orange

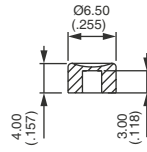

U4310

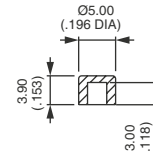

U4320

If not combined with bezel U4922, caps are to be ordered separately.

MOUNTING BEZEL

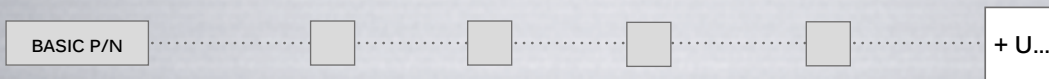

For 9500 model (case height 8 mm) only

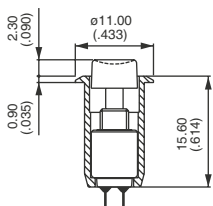

U4922

The mounting bezel U4922 has been designed to facilitate the mounting of the 9500 series pushbutton switch onto a panel. The switch + bezel assembly is snapped into the equipment through the front of the panel, then electrically connected by solder lug terminals.

Panel cut-out : Ø 8.15 mm ± 0.05 (.320 DIA ± .002)